

EJIW 3777-M / D&L A-1171
OR APPROVED EQUIVALENT

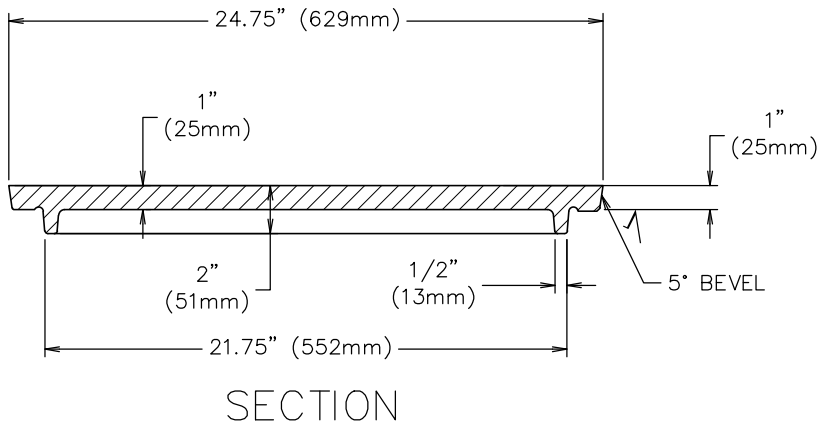

GENERAL NOTES:

1. FOR CITY-OWNED INFRASTRUCTURE ONLY. FOR PRIVATE STRUCTURES WITHIN THE RIGHT-OF-WAY PROVIDE A TEXTURED SLIP RESISTANT LID WITHOUT CITY LOGO - MUST HAVE "STORM WATER" ON LID.
2. DUE TO PROVISIONS IN THE INTERMODAL SURFACE TRANSPORTATION ACT, VENDORS MUST AUTHENTICATE U.S. ORIGIN OF CASTINGS FOR FEDERALLY FUNDED PROJECTS.
3. PROVIDE LIDS AND RINGS THAT MEET AASHTO 306 H20 LOADING RATING OR HIGHER.
4. ANGLED GRADE RINGS SHALL BE USED TO MATCH LID TO CROSS SLOPE AND RUNNING SLOPE OF THE ROAD
5. SEE STD-604A FOR STANDARD MANHOLE RING SPECIFICATIONS.
6. WHEN LOCATED WHERE MANHOLE MAY BECOME PRESSURIZED USE STD-605, "STORM WATER LOCKABLE LID AND FRAME".

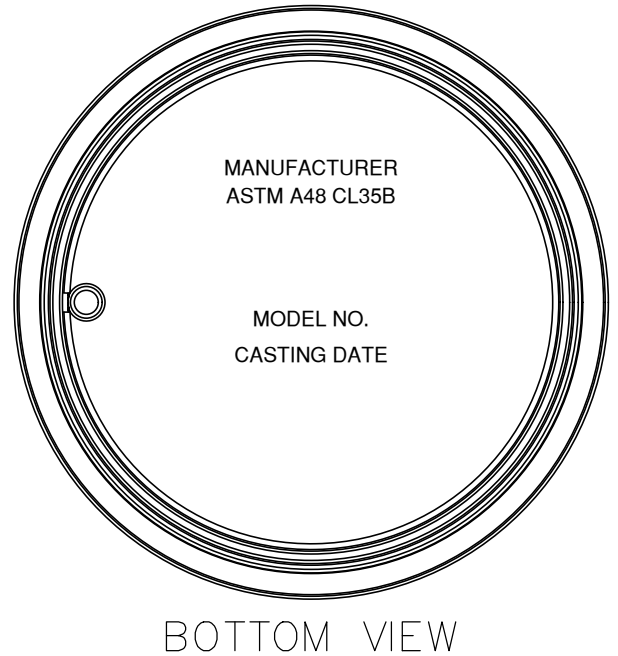
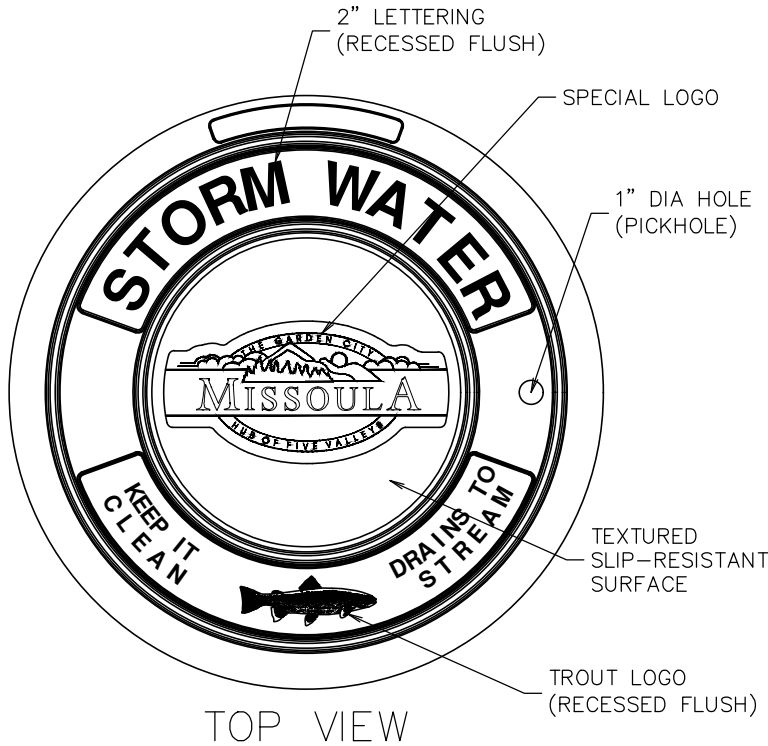

Engineering Division

Storm Water Solid Lid

AS

Approved By
Utility Engineer
Andy Schultz, PE

Revised: 09/28/2020

STD - 604B