

IMPROVE ALLEY PER MMC 12.12

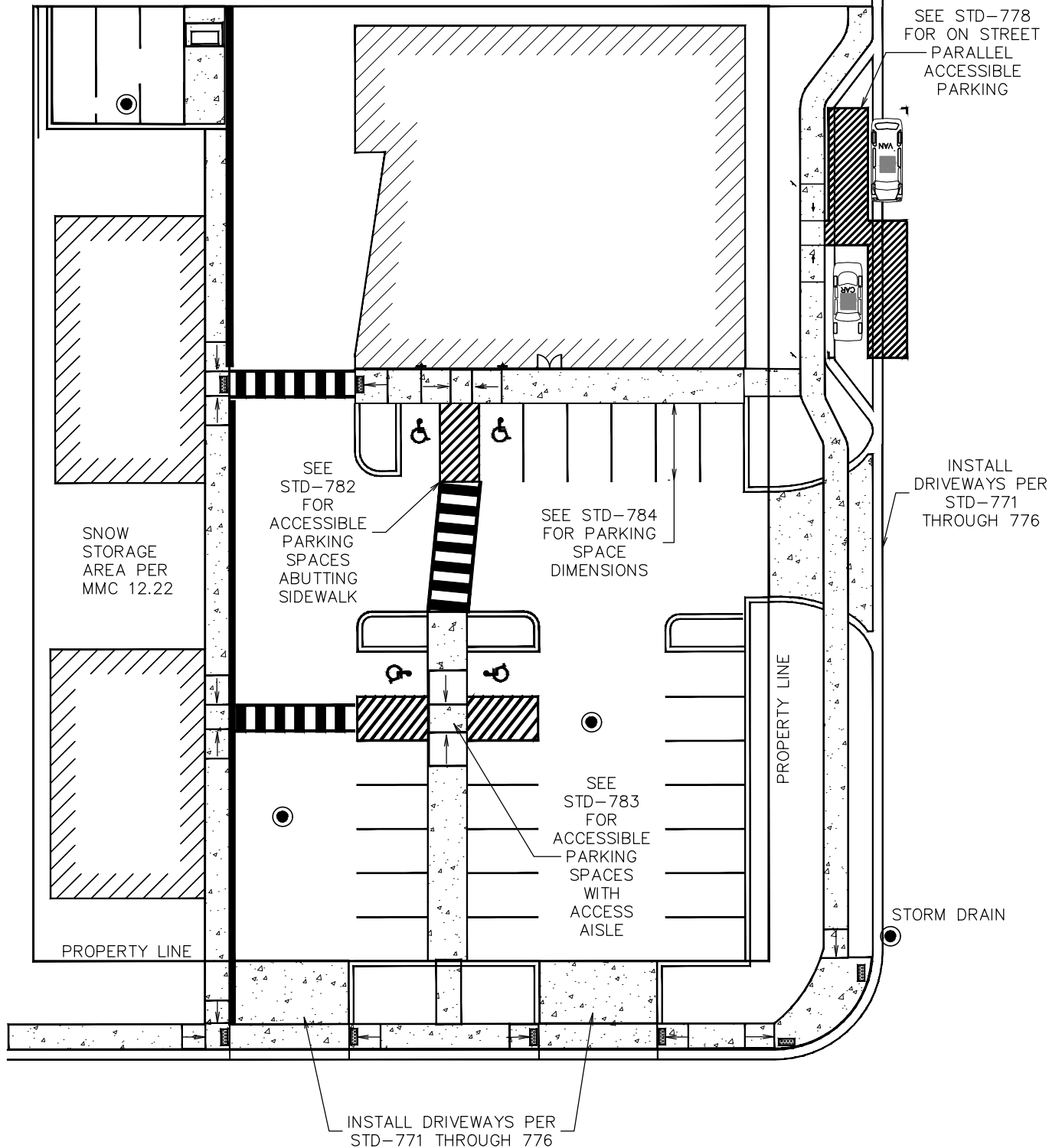

SEE STD-778
FOR ON STREET
PARALLEL
ACCESSIBLE
PARKING

INSTALL
DRIVEWAYS PER
STD-771
THROUGH 776

SNOW
STORAGE
AREA PER
MMC 12.22

SEE
STD-782
FOR
ACCESSIBLE
PARKING
SPACES
ABUTTING
SIDEWALK

SEE STD-784
FOR PARKING
SPACE
DIMENSIONS

SEE
STD-783
FOR
ACCESSIBLE
PARKING
SPACES
WITH
ACCESS
AISLE

STORM DRAIN

INSTALL DRIVEWAYS PER
STD-771 THROUGH 776



Engineering Division

Parking Facility Design Elements Key

Approved By
City Engineer
Kevin J. Slovark

Adopted: 02/27/1999
Revised: 01/13/2007

STD - 786